

# 120 mm/s

SMOOTH PRINTING  
WITHOUT PAPER JAMS

Long Standby 15 Days

Compatible ZPL, TSPL,  
CPCL, ESC/POS, JPL



### Two-color printing

Watermark Printing Two-color Printing

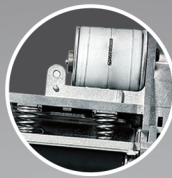

### Zinc alloy rack

Lightweight, High Strength And More Durable



### NFC

Mobile Phone Immediately Link with One Touch

### The Following Tests Have Third-Party Laboratory Certification



IP54 Water Proof And  
Dustproof Test Report



1.5m Drop Test Report



Static Test Report



High And Low Temperature  
Test Report

## Product Description

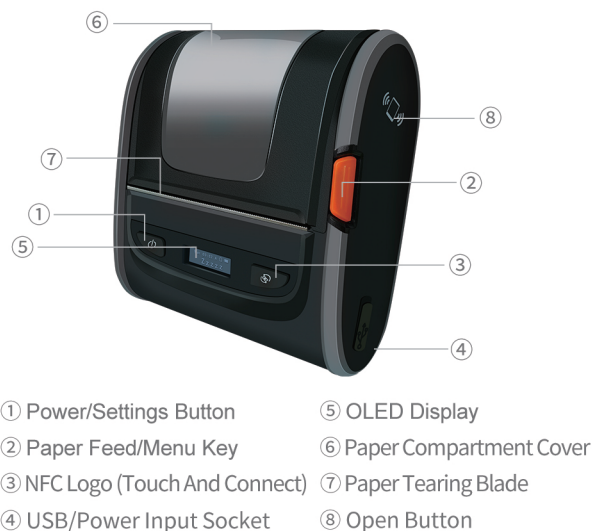

Exclusive App YinYin  
Make Printing Easier

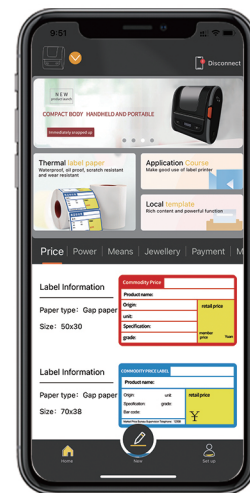

### Harsh Environment

High And Low Temperature Design, Able To Resist Harsh Environment The Conditions Still Work Normally.

### Dual-mode Bluetooth

Connect Multiple Android Phones At The Same Time, iPhone Can Also Print At High Speed, The Transmission Speed Can Be Up To 40KB/S.

### Multiple Instructions

Support CPCL, TSPL, ESC Command Command Automatic Identify The Switch.

### Rich Interface

TypeC Interface, Fast Charge, USB Positive And Negative Plug, Power Bank In-vehicle, Computer Power Strip, Charge the mobile phone charger.

### Express Face List

SF Express, Yunda, China Post, Zhongtong, Bestone, Dada Bond, Cainiao Package, Express 100

## Specifications

Printing Parameters	Resolution: 203 Dpi (8 Dots/mm)	Electrical characteristics	Interface Type: Type-C, Charger (Optional)		
	printing Method: Thermal Line Printing		Battery Capacity: 2500mAh/7.4V Rechargeable Lithium Battery		
	Printing Speed: Up To 120 mm/s		Charging Time: 3~3.5 hours; computer USB: 4 hours		
	Printing Density: 576 Dots/Line		Standby Time: No Less Than 15 Days		
	Maximum Printing Width: 72mm		Number Of Continuous Printing Sheets: 1300~1400 Sheets (Sheet Height: 200mm)		
Physical Characteristics	Case Material: PC+ABS, TPU soft rubber		Reliability	Power Adapter: Input AC 100~240V, 50~60Hz, Output DC 5V, 2000mA	
	Dimensions: 118(D)×105(W)×62(H) MM			Detection Function (Sensor): Positive And Negative Black Mark, Gap Detection, Lack Of Electricity, Lack Of Paper, Open Cover, Overheating Alarm	
Environmental Conditions	Weight: 450g			Software Function	TPH Life (Printing Length): 50 Kilometers
	Operating conditions: -0℃~52℃, humidity (non-condensing) 10~85%				Number Of Pulses: 1.0 x 10 To The 8th Power Pulses (Printing Rate 12.5%)
Paper Specifications	Storage Conditions: -20℃~60℃, Humidity (non-condensing) 5~90%				Character Set
	Paper Type: Gap Paper, Continuous Paper, Front, And Back black Mark Paper	IP Protection Level: IP54 (With Third-party Laboratory Certification)			
	Media Width: 30~80mm	Android/IOS Printing And Editing Software			
	Medium Height: Minimum 15mm	Windows Driver			
	Paper thickness: 0.053mm~0.16mm	WeChat Print Applet			
	Paper roll Diameter: Up To 50mm	Bar Tender Software			
	Peeling Mode: Tearing Blade	Communication Interface	Characters: Simplified Chinese GB18030, Traditional Chinese BIG5, Korean KSC5601, Japanese (optional)		
Gap Height: Minimum 2mm	Vector Font Library: Default Siyuan Boldface				
Black Mark Height: Minimum 2mm	Articles: UPC-A, UPC-E, EAN-8, EAN-13, Code128, Code 39, Codabar, Code 93, ITF, Interleaved 2 of 5, etc.				
Storage	Flash: 16 MB	Screen Operation Interface language: Chinese, English	Two-Dimensional Code: QR Code, PDF417, Data Matrix		
	RAM: 8 MB		Character And Barcode Rotation: 0°, 90°, 180°, 270°		
Communication Interface	USB 2.0 (Standard)		Special Printing Function: Watermark Printing (Optional), Two-color Printing (Optional)		
	Bluetooth 4.2 (Standard Configuration)		Operating Switches, Buttons, Display Screen: Power Button, Paper Output Button, Lid Open Button, OLED Display		
	Bluetooth 5.0 (Optional)	Product Standard Number: GB/T29267-2012			
Processor: Cortex-M7	WIFI 2.4G/5G (Optional)	Radio Model Approval Code: Bluetooth CMIIT ID: 2020DP5109(M)			
Instruction Set: TSPL, CPCL, ESC/POS, ZPL, JPL					